

ACCESSORIES FOR OPERATING TABLE

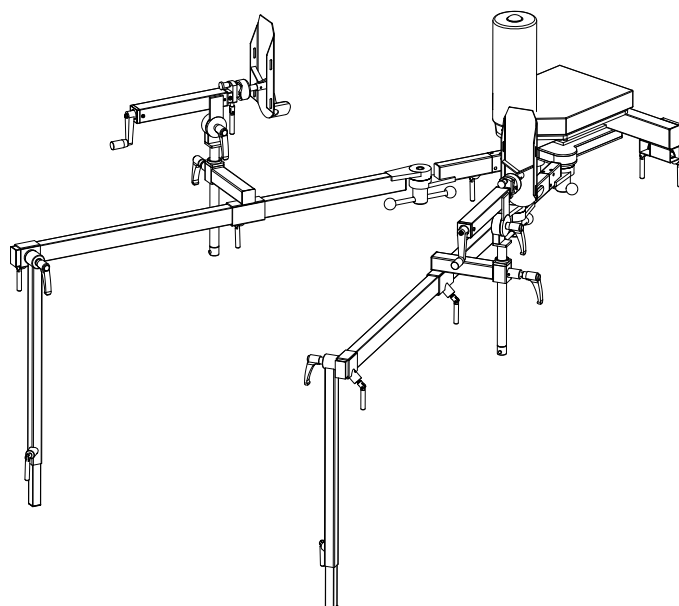

o1019a.eps

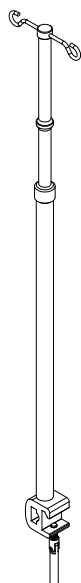
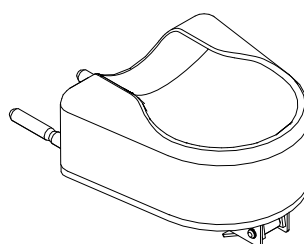
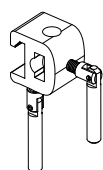

MERIVAARA

Merivaara Corp.

Puustellintie 2, FI 15150 LAHTI, FINLAND

Tel. +358 3 3394 611 • Fax +358 3 3394 6144

merivaara@merivaara.fi

www.merivaara.com

1	GENERAL	4
2	TECHNICAL SPECIFICATIONS	5
	2.1 Properties and materials	5
	2.1.1 Conditions	5
	2.1.2 Choice of accessories	5
	2.1.3 Bowls	7
	2.1.4 Head rests	8
	2.1.5 Arm rests	9
	2.1.6 Leg rests	10
	2.1.7 Shoulder and side supports	11
	2.1.8 Table top parts of operating table	12
	2.1.9 Racks and et cetera	13
	2.1.10 Locks, straps and positioners	14
	2.1.11 Other accessory devices	15
	2.1.12 Other accessories	16
3	PRODUCT USE	17
	3.1 Implementation	17
	3.2 Assembly and use	17
	3.2.1 Bowls and utility basket	17
	3.2.2 Head rests	18
	3.2.3 Arm and hand table	19
	3.2.4 Arm rests	19
	3.2.5 Leg rests	20
	3.2.6 Arthroscopic supports	21
	3.2.7 Side and shoulder supports	21
	3.2.8 Table top parts of operating table	22
	3.2.9 Racks and et cetera	23
	3.2.10 X-ray cassette trays, leg rests and side rail	24
	3.2.11 Fixing straps	25

4	CLEANING	26
	4.1 Cleaning and disinfection	26
	4.1.1 Disinfection	26
	4.1.2 Drying	26
5	SPARE PARTS	27
	5.1 Arm rest 125	27
	5.2 Devided foot section for model 100000148 for OP1650 and OP1700	28
6	RECYCLING	30
	6.1 Metals and plastics	30
	6.1.1 Gas springs	30
	NOTES	31
	ORDER FORM	32

1. GENERAL

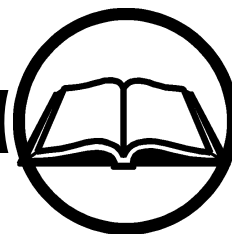

The safe and problem-free use and maintenance of accessories requires careful adherence to these instructions. When mounting accessories, the instructions provided with them must be followed closely.

Warnings and comments are indicated as follows:



WARNING!

Please observe to ensure user, maintenance personnel and patient safety.



CAUTION!

Please observe in order to avoid causing damage to the equipment or its parts.



NOTE!

Please observe in order to improve operating table properties.



WARNING! Do not use worn or damaged accessories. Ensure that all accessories are properly mounted and check the functioning of the accessory locking and adjustments!

Expertise is essential

The patient is the most important part of treatment. This is precisely why the equipment used in treatment must be absolutely safe and convenient to use. As a health care professional, you deserve the very best tools, allowing you to concentrate on your own field of expertise. Merivaara is an expert in providing hospital equipment.

Merivaara products have been designed to function efficiently and flexibly during the various stages of treatment. They assist you in the performance of your work, without distracting you from the task at hand. Our modular equipment system includes state-of-the-art equipment for hospital procedures and hospital room environments as well as for nursing homes and home care applications.

For more information on Merivaara products, contact our Sales Office. For matters related to equipment servicing, contact the Merivaara Service Department.



2. TECHNICAL SPECIFICATIONS



2.1 Properties and materials

2.1.1 Conditions

Ambient temperature	+10 ... +40 °C
Ambient pressure	700 ... 1060 mbar
Relative humidity	30 % ... 75 %
Transport temperature	-10 ... +40 °C
Storage temperature	+10 ... +40 °C

2.1.2 Choice of accessories

	107	110	111	116	118	120	125	126	141	142	144	147
Rapido	X	X	X	X	X	X	X		X	X	X	
OP 1700	X	X	X	X	X	X	X	X	X	X	X	X
OP 1650	X	X	X	X	X	X	X	X	X	X	X	X
Promerix and Promerix B3	X	X	X	X	X	X		X	X			
Practico (1000 30 000)	X	X	X	X	X	X		X				

	148	151	154	156	158	749	11001	11042	11043	11081	11181	11651
Rapido		X				X	X	X	X	X	X	X
OP 1700	X	X	X	X	X	X	X	X	X	X	X	X
OP 1650	X	X	X	X	X	X	X	X	X	X	X	X
Promerix and Promerix B3		X				X	X	X	X	X	X	X
Practico (1000 30 000)		X				X	X	X	X	X	X	X

	11652	11801	11802	11911	11912	12001	12390	12530	12551	60146	18001	12552
Rapido	X	X	X	X	X		X	X	X		X	X
OP 1700	X	X	X	X	X	X	X	X	X			X
OP 1650	X	X	X	X	X	X	X	X	X			X
Promerix and Promerix B3	X	X	X	X	X		X			X		X
Practico (1000 30 000)	X	X	X	X	X		X					X

	12572	12581	12583	12585	12586	12590	18101	18126	18143	181581	181582
Rapido	X	X	X	X	X	X	X	X	X	X	X
OP 1700	X	X	X	X	X	X	X		X		
OP 1650	X	X	X	X	X	X	X		X		
Promerix and Promerix B3	X	X	X	X	X	X	X		X		
Practico (1000 30 000)	X	X	X	X	X	X	X		X		

	18161	18173	18174	18183	18189	18261	19128	19129	19180	19185	19220	19280
Rapido	X	X	X	X	X	X	X	X	X	X	X	X
OP 1700		X	X				X	X	X	X	X	X
OP 1650		X	X				X	X	X	X	X	X
Promerix and Promerix B3		X	X				X	X	X	X	X	X
Practico (1000 30 000)		X	X				X	X	X	X	X	X

	20201	19300	40201	40204	40308	40617	10659	60600	10200	10300	19180	19185
Rapido			X	X	X	X	X		X	X	X	X
OP 1700			X	X	X	X	X		X	X	X	X
OP 1650			X	X	X	X	X		X	X	X	X
Promerix and Promerix B3		X	X	X	X	X	X	X	X	X	X	X
Practico (1000 30 000)	X	X	X	X	X	X	X		X	X	X	X

	18159
Rapido	X
OP 1700	X
OP 1650	X
Promerix and Promerix B3	X
Practico (1000 30 000)	X

2.1.3 Bowls

	1000181581	1000181582	100018159	100018183	100018189
Weight kg/pcs	3,0	3,2	0.75	0,75	2,25

	100000158
Weight kg/pcs	1,6

Table 1.

Bowl 6 l

100181581 without hose

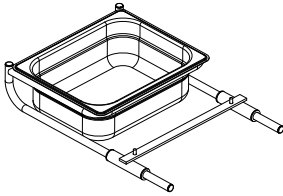

Bowl 6 l

(100181582) with hose

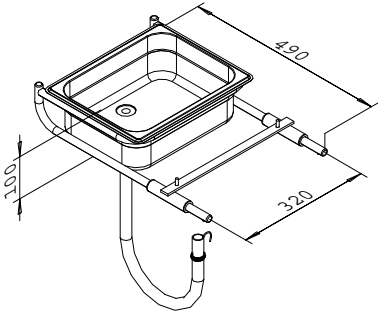

Screen (6l)

(100018159)

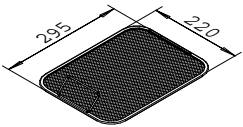

Utility basket

(100018183)

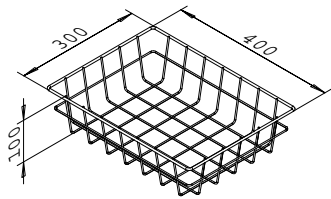

Oxygen bottle holder 5l

(100018189)
(nom. d=140)

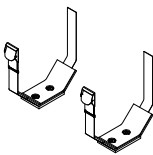

Bowl 4 l

(100000158)

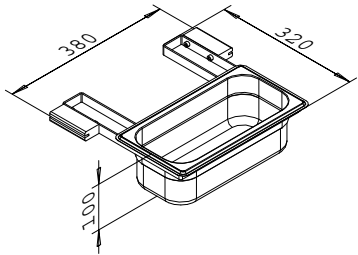

2.1.4 Head rests

	100000141	100000142	100018143	100018101	100000140	100000144
Weight kg/pcs	4,1	3,5	3,5	4,1	7,0	3,4

	100000151	100018150	100018151
Weight kg/pcs	2,4	3,0	3,25

Table 2. Weight

Wide head rest (100000141)

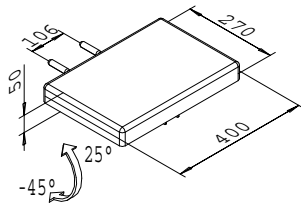

Narrow head rest (100000142)

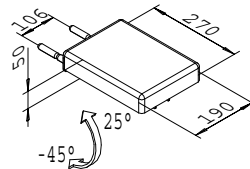

Head rest (ent) (100018143)

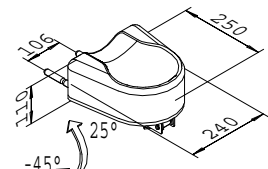

Head rest (100018101)

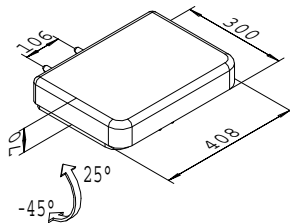

Head rest (100000140)

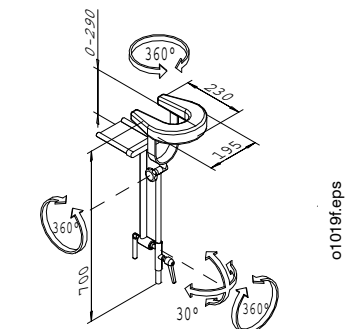
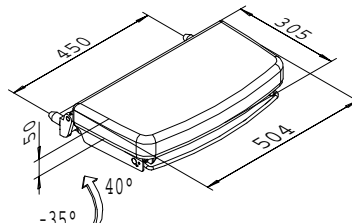

Arm rest, pair (ophthalmology) (100000151)

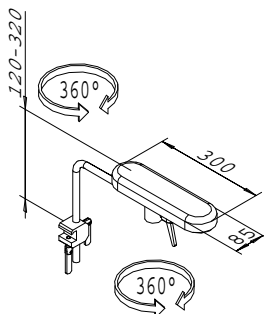

Special head rest (ophthalmology) (100018150) single joint mechanism Height adjustment 0 / +210 mm

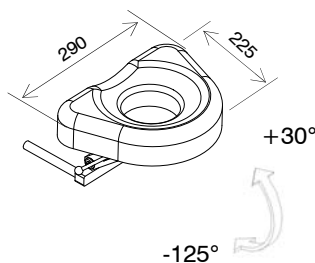

Special head rest (ophthalmology) (100018151) double joint mechanism, wide range Height adjustment -70 / +385 mm

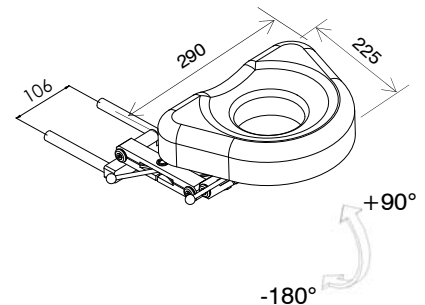

2.1.5 Arm rests

	100011802	100011912	100011911	100000125	100019180	100011801
Weight kg/pcs	3,2	4,2	5,4	6,2	6,1	2,2

	100010659	100019185
Weight kg/pcs	1,6	

Table 3. Weight

Lateral armboard, (100011802) and clamp (100011042)

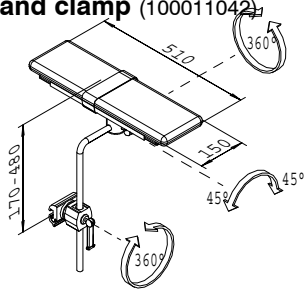

Carpa table (100011912)

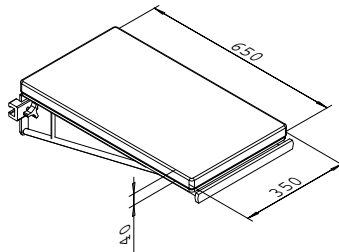

Arm and hand table (100011911)

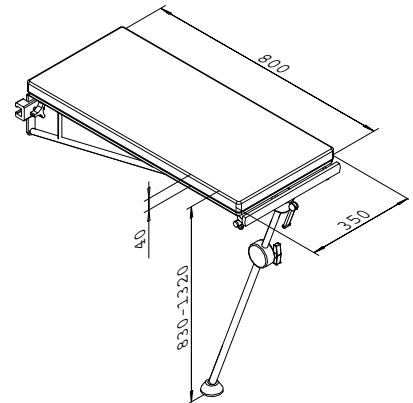

Arm rest (100000125)

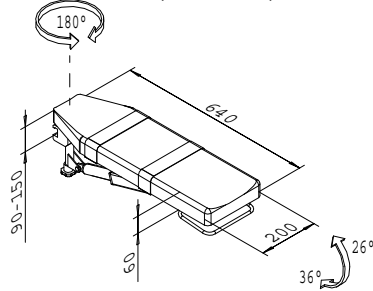

Arm rest (100019180)

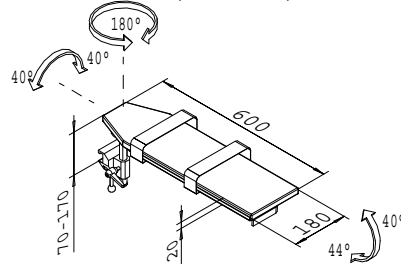

Easy armboard (100011801)

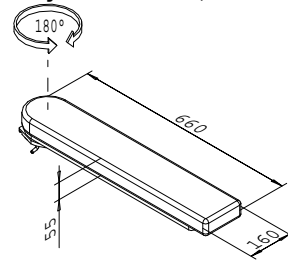
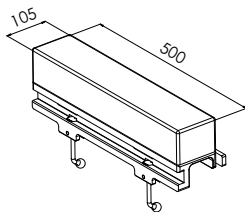
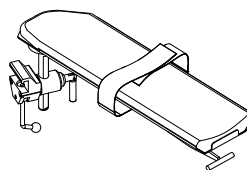

Table width extender (100010659)



Arm rest with radial clamp (100019185)



o1019b.eps

2.1.6 Leg rests

	100011181	100000118	10012552	100012551	100012583	100012581
Weight kg/pcs	2,8	5,1	2,4	2,8	5,6	5,3

	100012590
Weight kg/pcs	2,6

Table 4. Weight

Knee crutches, pair (100011181) and clamp, (100011042)

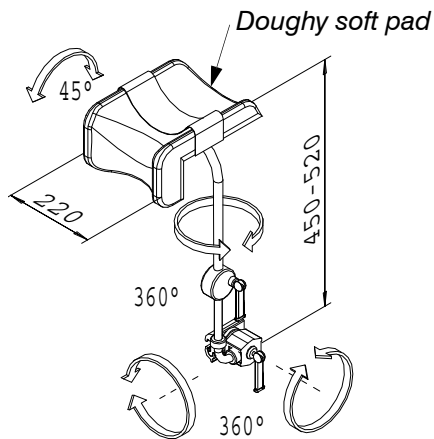

Leg rest, pair (100000118)(geopel) separate clamps needed

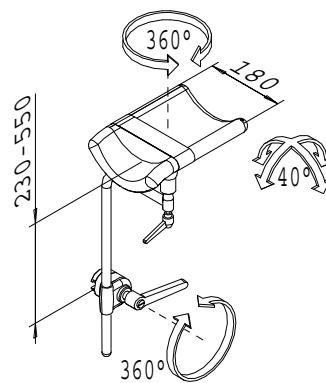

Prepper, (100012552) and clamp, (100011042)

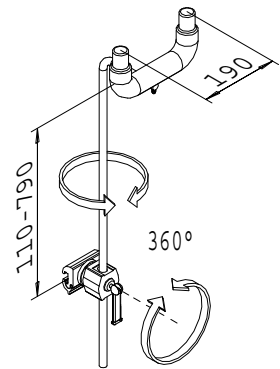

Leg holder, pair (100012551) and clamp (100011042)

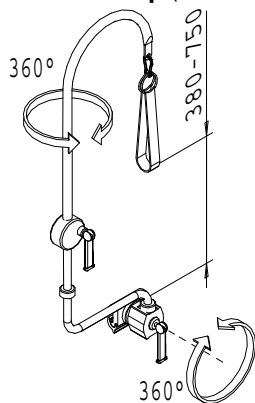

Stirrups system, pair (100012583) and clamp (100011043)

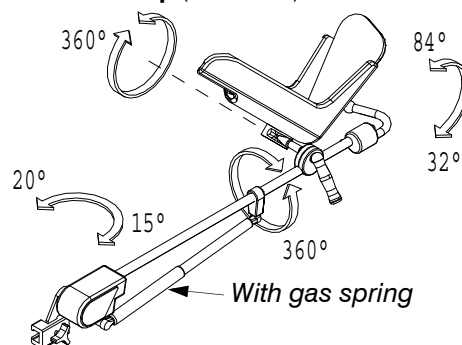

Stirrups system, pair (100012581) and clamp (100011042)

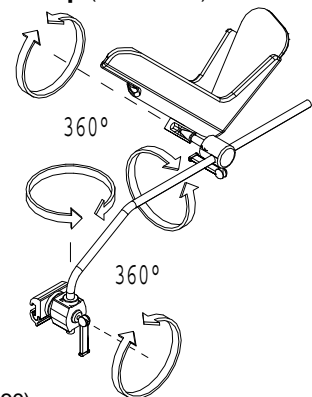

Pediatric stirrups, pair (100012590) separate clamps needed

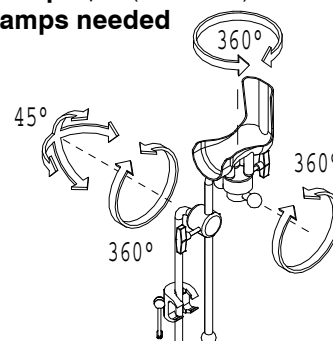

2.1.7 Shoulder and side supports

	100011651	100011652	100000120	100019129	100012585	100012586
Weight kg/pcs	1,5	1,7	1,6	1,6	1,5	< 0,1

	100012530
Weight kg/pcs	1,5

Table 5. Weight

Lateral brace, (100011651)
Pad width 105 mm

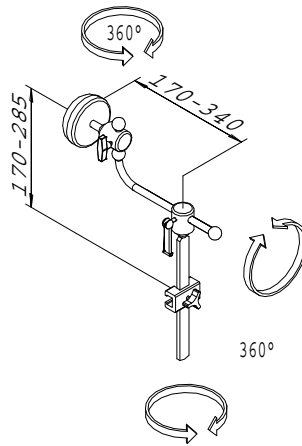

Lateral brace, (100011652)
and clamp, (100011043)
Pad height 220 mm

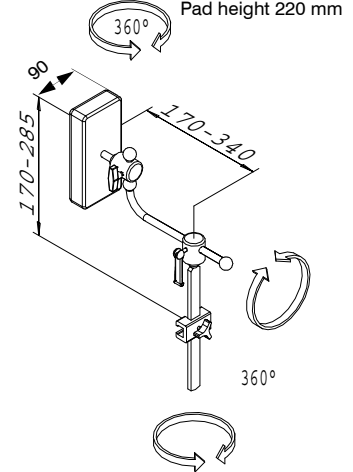

Side support, (100000120)

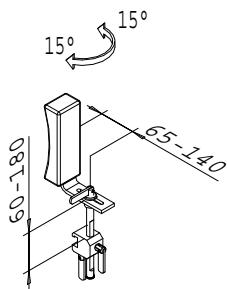

Shoulder support, pair (100019129)

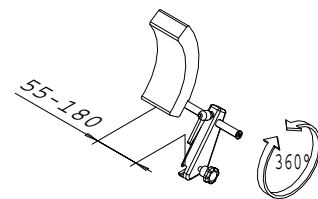

*** Total knee stabilizer**
(100012585)

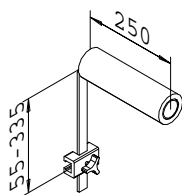

*** Pad, for total knee stabilizer 100012585**
(100012586)

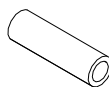

*** Arthroscopic stress post, (100012530)**
and clamp, (100011042)

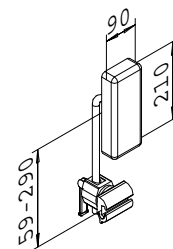

***) accede in knee arthroscopy**

2.1.8 Table top parts of operating table

	100000148	100018261	100000154	100000147	100018161
Weight kg/pcs	19,8	14,6	18,0	15,5	15,5

Table 6. Weight

Divided foot section

(100000148, X=230 fit in OP 1700 and OP1650)

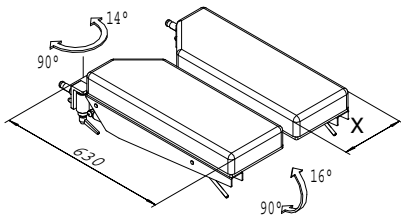

Divided foot section

(100018261, X=280 fit in Rapido)

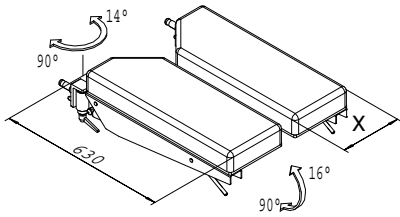

Proctology accessory

(100000154 fit in OP 1700 and OP1650)

Leg section

(100000147 fit in OP 1700 and OP1650)

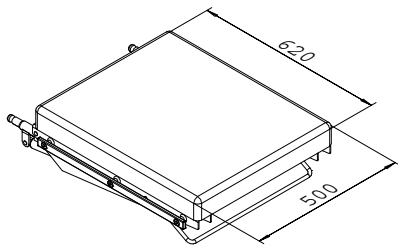

Leg section

(100018161 fit in Rapido)

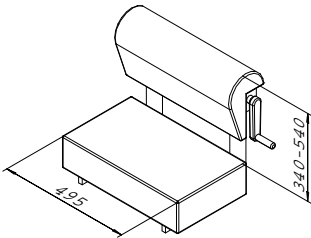
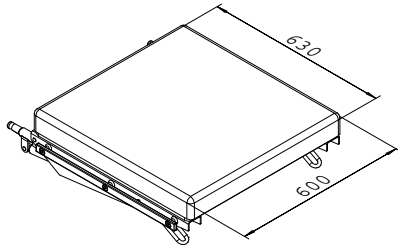

o1019h.eps

o1019be.eps

2.1.9 Racks and et cetera

	100000111	100000116	100000749	100019128	100011001	100018128
Weight kg/pcs	2,3	0,5	1,8	2,8	1,3	2,5

	100000126	100012001	100018173	100018174
Weight kg/pcs	2,2	2,4	3,0	3,0

Table 7. Weight

Anesthesia screen (100000111)

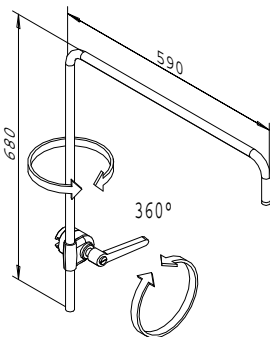

Extension arm for anesthesia screen (100000116)

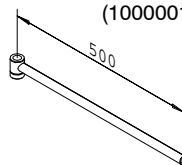

Infusion rod (100000749)

2 or 4 hooks

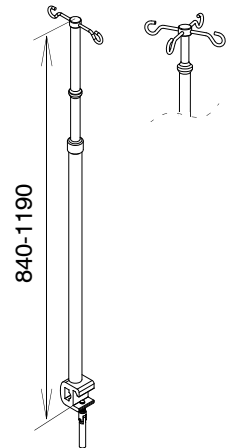

Flexible anesthesia screen (100011001)

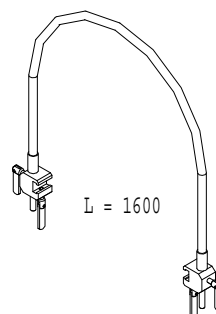

Accessory rail extension (100019128)

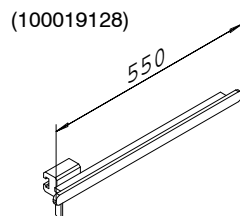

X-ray cassette tray (100018126)

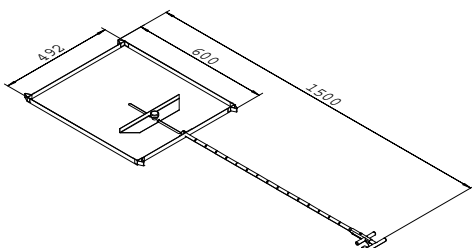

X-ray cassette tray (100000126)

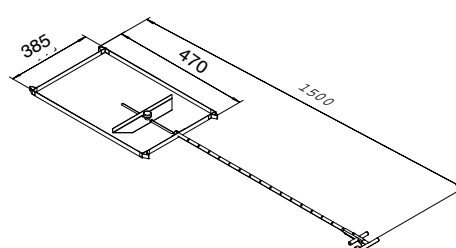

Light foot rest (100012001)

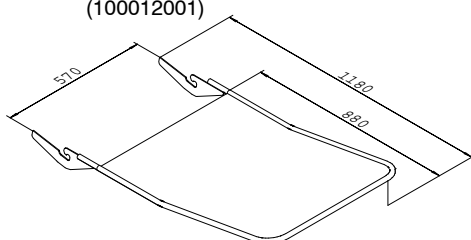

Side rails (100018173) chromed and (100018174) painted

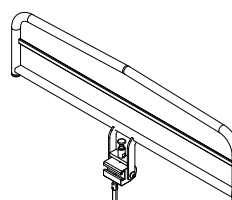

o1019j.eps

o1019k.eps

2.1.10 Locks, straps and positioners

	100000107	100000110	100011081	100010300	100011042	100010200
Weight kg/pcs	0,3	< 0,1	1,0	0,8	0,6	0,4

	100011043	100040204	100040201	100040308	100040617
Weight kg/pcs	0,2	1,1	1,2	1,0	3,4

Table 8. Weight

Wrist straps, pair
(100000107)

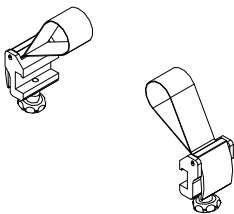

Straps

(100000110)
Lenght 800 mm

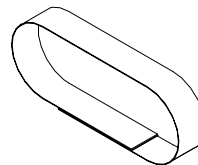

Patient restraint strap

(100011081)

Padding width 130 mm
Lenght 610-1510 mm

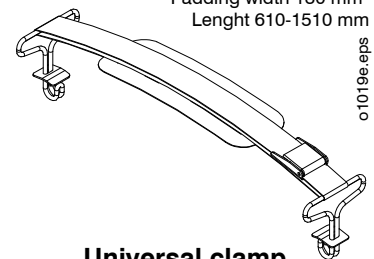

o1019e.eps

Radial universal clamp
(100010300)

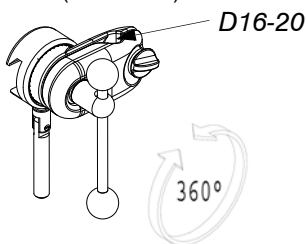

Easy lock clamp
(100011042)

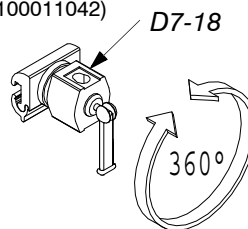

Universal clamp
(100010200)

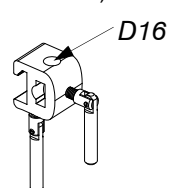

Rail clamp
(100011043)



Horseshoe donut head pad
(100040204)

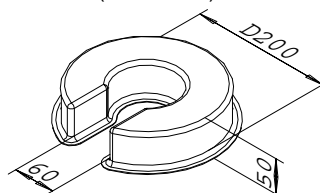

Donut head pad
(100040201)

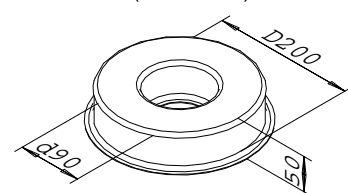

Large armboard pad
(100040308)

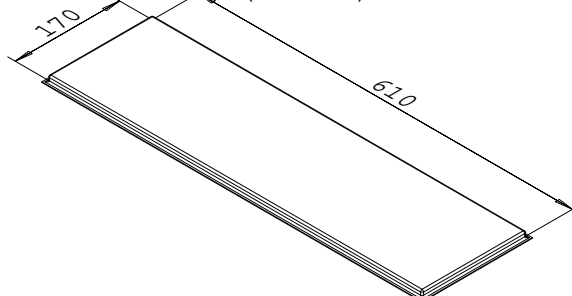

Patient positioner, flat bottom
(100040617)

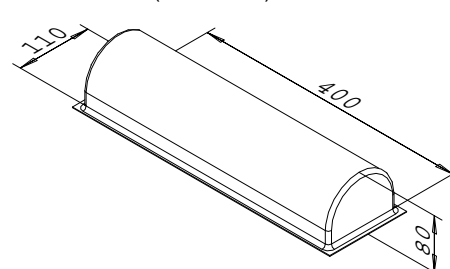

o1019c.eps

2.1.11 Other accessory devices

	100000156	100060600	100019300
Weight kg/pcs	50,5	28,9	37,9

Table 9. Weight

Orthopedic extension device
(100000156)

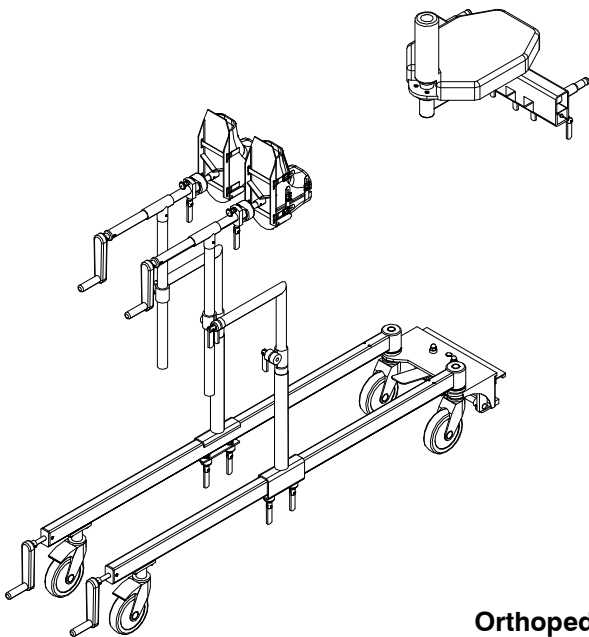

Knee Chest Device
(100060600)

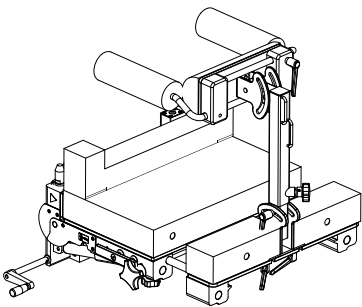

Orthopedic extension device
(100019300)

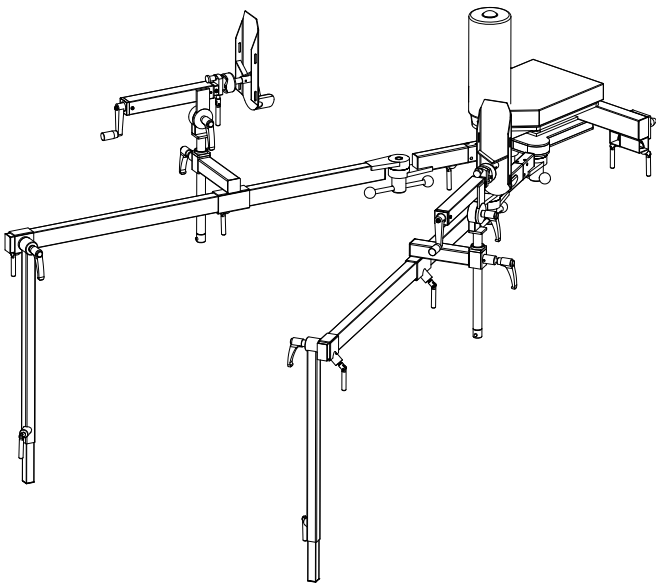

2.1.12 Other accessories

	100019220	100019280
Weight kg/pcs	28,8	8,8

Table 10. Weight

Accessory stand
(100019220)

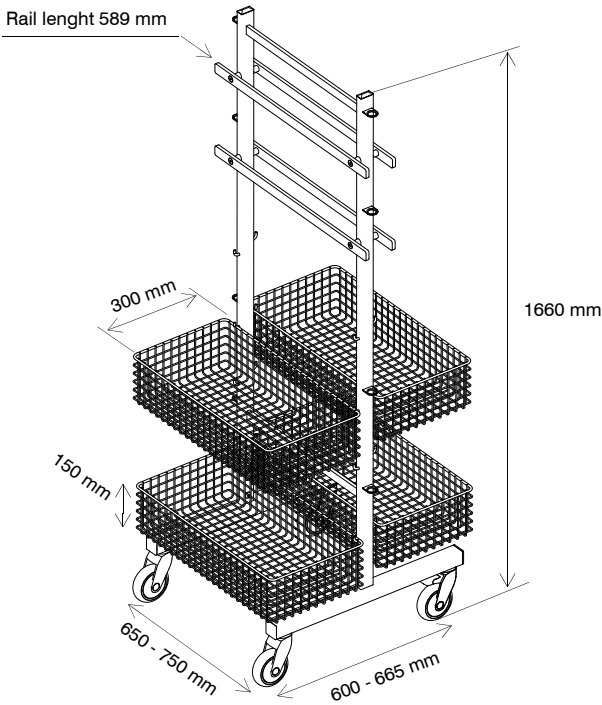

Back and kidney elevator
(100019280)

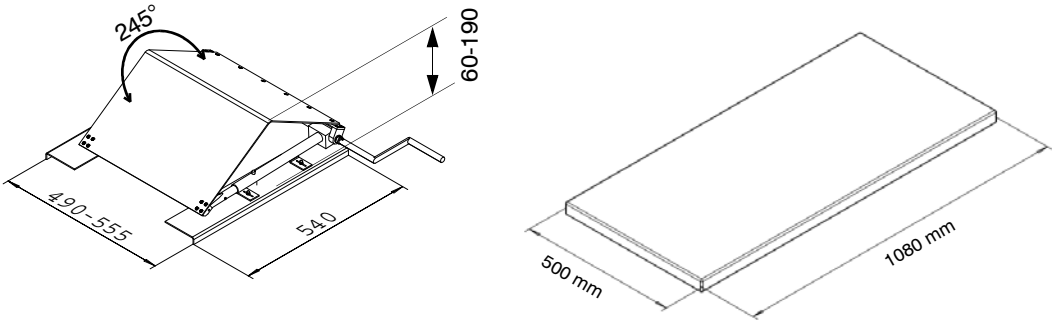

01019i.eps

3. PRODUCT USE

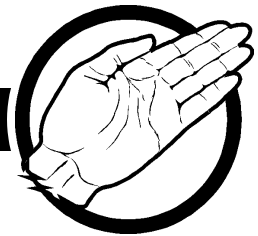

3.1 Implementation

Check the package contents for any damages that may have been caused during transport. Cardboard packing materials should be recycled. Wood and plastic are energy waste.

3.2 Assembly and use

3.2.1 Bowls and utility basket

18158

Fix slide bowl rail (1) underneath operating table seat section with two hex screws M6x16 (2).

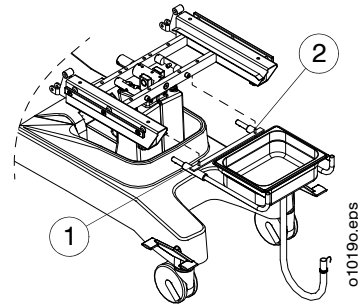

18183

Utility basket will be fixed with two binders (1) to protective casing.

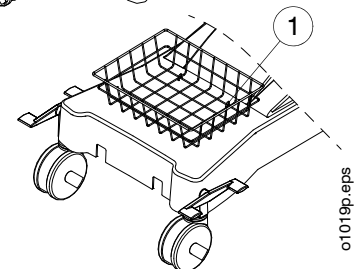

158

Push bowl frame (1) to X-ray cassette tray rails.

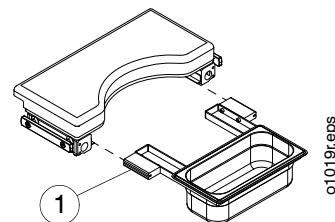

18189

Oxygen bottle holders (1) will be fixed with screws (2) and nut plate (3) to protective casing.

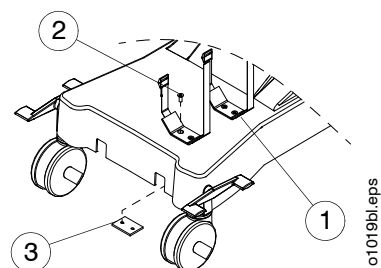

3.2.2 Head rests

141, 142, 18143 or 18101

Push head rest to it's place and tighten hand screws (1).
Angle adjustment by gas spring, operates with lever (2).

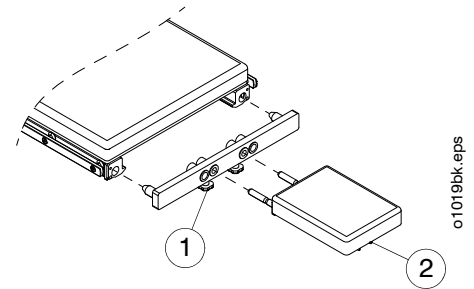

144

Head rest fixed as above.

Height adjustment with screw (1).

Distance adjustment with screws (2) and (3).

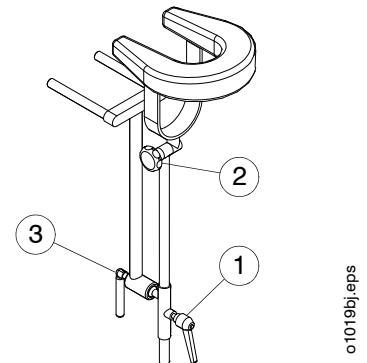

151

Fix arm rest to accessory rail
with screw (1).

Height adjustment with screw (2).

Arm rest positioning with screw (3).

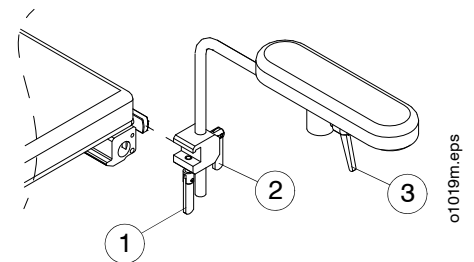

3.2.3 Arm and hand table

11911 or 11912

First fix clamps (1) to their places and lower arm and hand table on locks.

Adjust height and tighten locks.

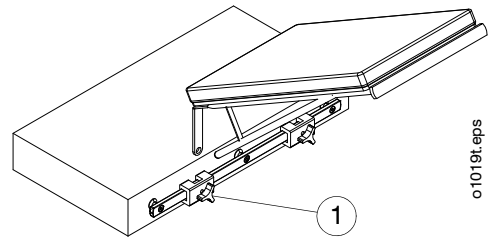

3.2.4 Arm rests

11801

Open locking catch (1) and fix armboard to its place by leaning, as shown in picture.

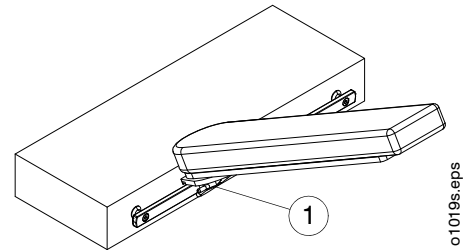

19180

Turn locking catch (1) down and push arm rest to accessory rail. Lock by turning locking catch sideways. Adjust height and tighten with screw (2). Angle adjustment with lever (3).

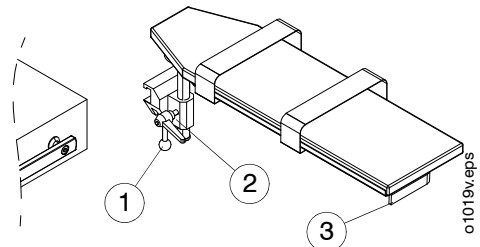

19185

Lock the hand rest by turning the lever (1) to horizontal position. Adjust height and tighten with joint screw (2). Angle adjustment with quick lever (3).

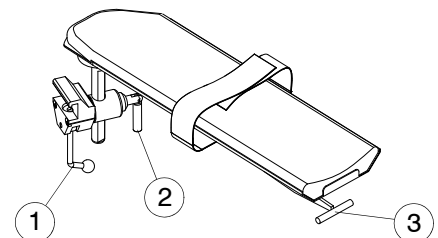

125

Fix arm rest to accessory rail and tighten with screw (1). Adjust height and tighten with screw (2). Angle adjustment with lever (3).

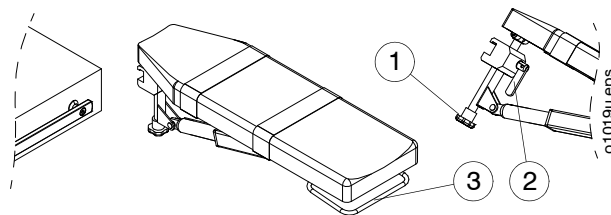

11802+11042

Fix clamp (1) and armboard to accessory rail and tighten with screw (2). Adjust rest and tighten with screw (3).

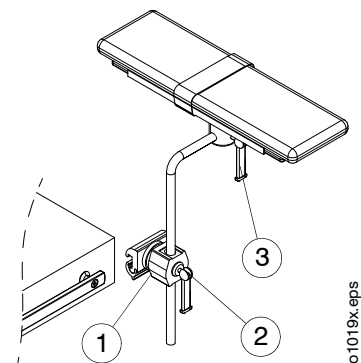

3.2.5 Leg rests

11181+10300

Fix clamp (1) and knee crutches to accessory rail and tighten with screw (2). Side tilt with screw (2) and height with screw (3).

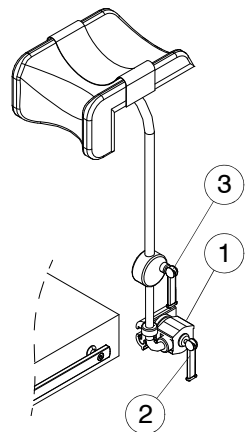

12583+11043

First fix clamp (1) and lift stirrups system between accessory rail and lock. Tighten with screw (2). Angle adjustment by gas spring, operates with lever (3), and side tilt with screw (4).

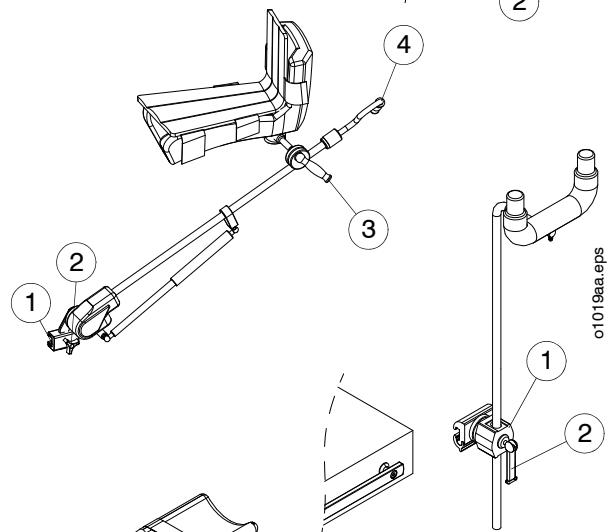

12552+11042

Fix clamp (1) and prepper to accessory rail and tighten with screw (2). Height adjustment with screw (2).

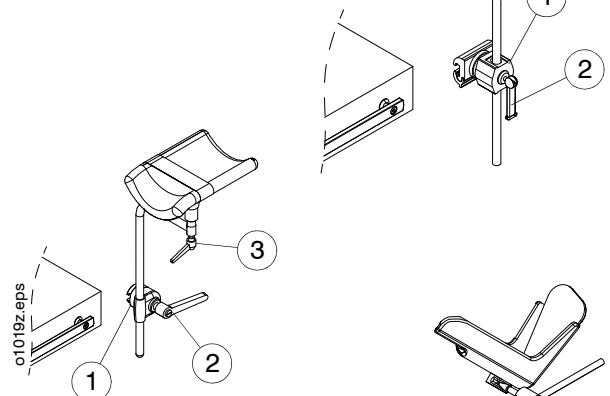

118+10300

Fix clamp (1) and leg rest to accessory rail and tighten with screw (2). Adjust rest and tighten with screw (3).

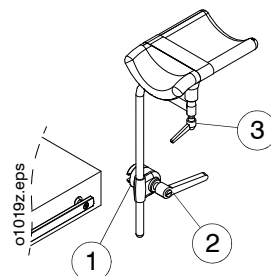

12581+11042

Fix clamp (1) and stirrups system to accessory rail and tighten with screw (2). Distance and side tilt adjustments with screw (3).

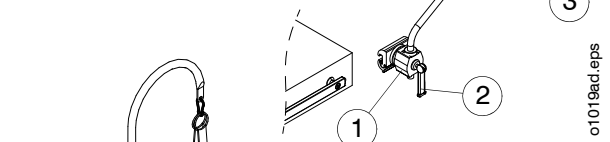

12551+11042

Fix clamp (1) and leg holder to accessory rail and tighten with screw (2). Height adjustment with screw (3).

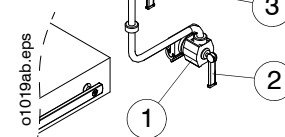

12590+10200

Fix clamp (1) and pediatric stirrups to accessory rail and tighten with screw (2). Height adjustments with screws (2) and (3). Boot positioning with screw (4).

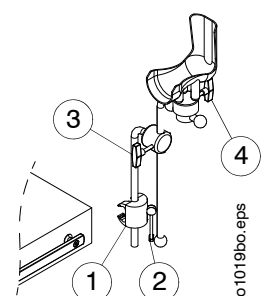

3.2.6 Arthroscopic supports

12531+11042

Fix clamp (1) and arthroscopic stress post to accessory rail and tighten with screw (2).

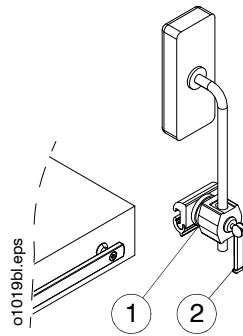

12530+11043

Fix clamp (1) and total knee stabilizer to accessory rail and tighten with screw (2).

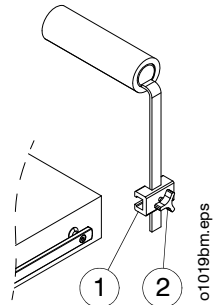

3.2.7 Side and shoulder supports

11651+11043 and 11652+11043

Fix clamp (1) and lateral brace to accessory rail and tighten with screw (2). Angle adjustment with screws (3) and (4).

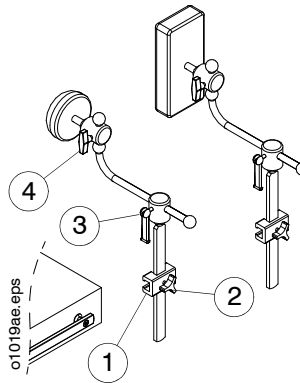

120

Fix side support to accessory rail and tighten with screw (1). Height adjustment with screw (2) and distance adjustment with screw (3).

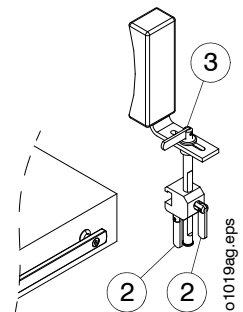

19129

Fix shoulder support to accessory rail and tighten with screw (1). Distance and angle adjustments with screw (2).

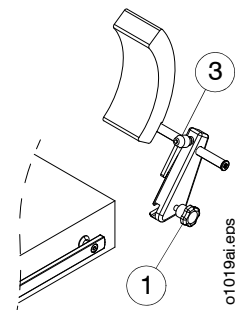

3.2.8 Table top parts of operating table

148 or 18261

Fix separate leg section and tighten screw (1).

Tilt adjustment by gas spring, operates with lever (2) and angle adjustment with screw (3).

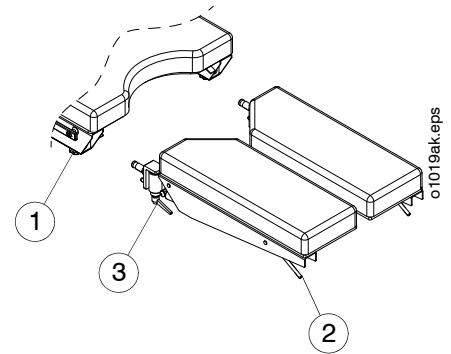

10659

Open locking levers (1) to vertical position and mount the table width extender to the accessory rail. Turn the both levers horizontally to lock the table width extender.

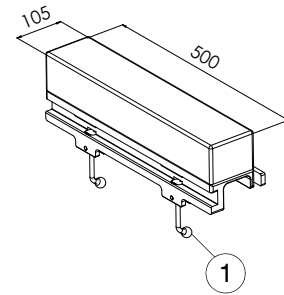

3.2.9 Racks and et cetera

111+10300

Fix clamp (1) and anesthesia screen to accessory rail and tighten with screw (2).

116

Fix extension arm to needed height and tighten with screw (3).

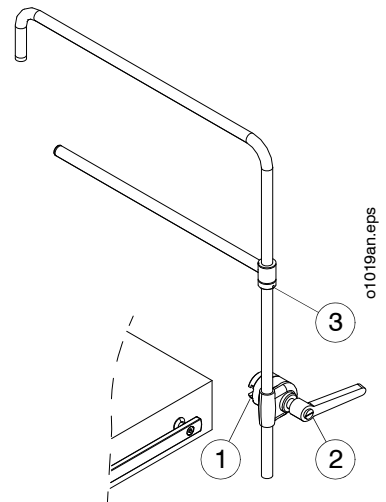

749

Fix infusion rod to accessory rail and tighten with screw (1). Adjust height with push/pull collar (2).

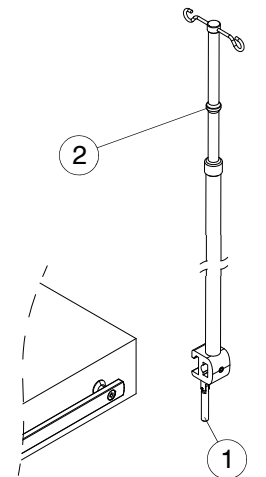

19128

Fix accessory rail extension and tighten with screw (1).

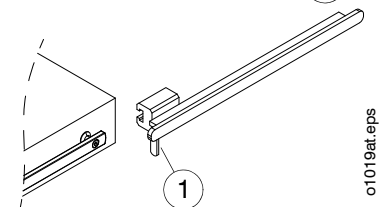

11001+ 10200

First fix suoraslta (1) to accessory rail and bend anesthesia screen in place. Tighten with screw (2) and (3).

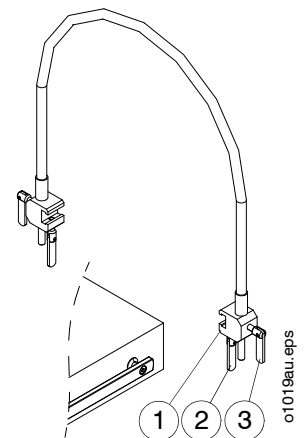

3.2.10 X-ray cassette trays, leg rests and side rail

126 or 18126

Push X-ray cassette tray on rails underneath operation table top. X-ray cassette locking with cassette holder hand screw (1). Squeezing handle (2) makes arm (3) stiff and allows cassette tray movements.

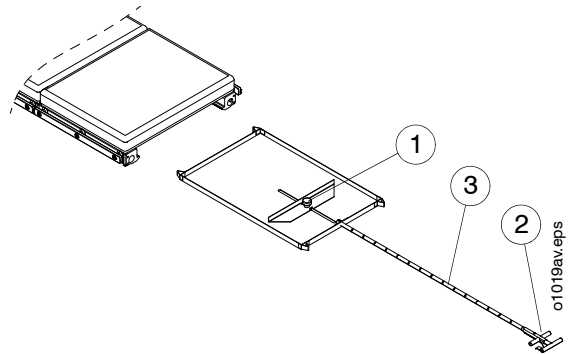

12001/18001/20201

Bend locking bars (1) inwards to fit bars between accessory rail and frame.

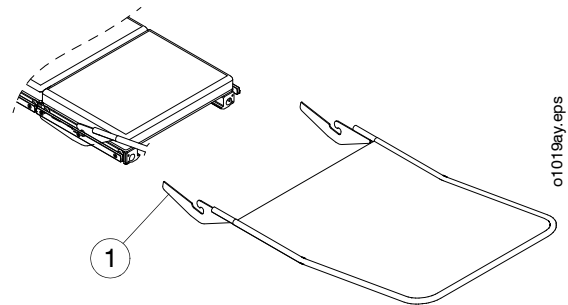

18173/18174

Fix the foldable side rail to accessory rail and tighten with joint screw (1). Pull locking pin (2) up and lower rail sideways down.

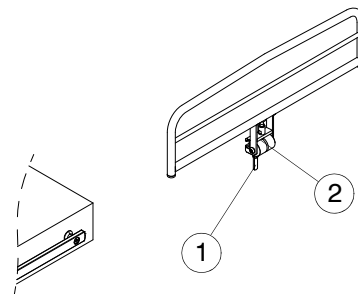

19280

Fix back and kidney elevator on operating table top. Adjust side fixings (1) to right width and tighten screws (2). Bending height adjustment with handle (3).

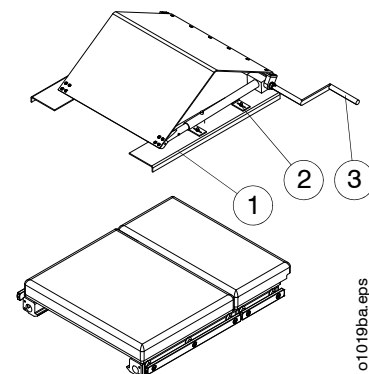

3.2.11 Fixing straps

107

Fix locks to accessory rail and tighten with screws (1).
Tighten strap and press lever (2) down.

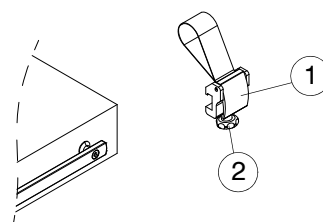

11081

Fix hooks to accessory rail. Tighten strap (1)
and press lever (2) down.

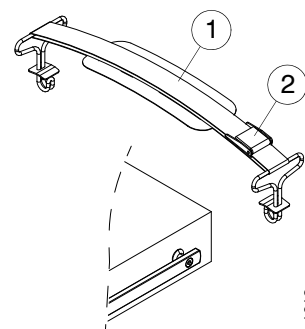

4. CLEANING

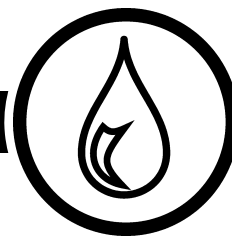

4.1 Cleaning instructions



WARNING! Merivaara operating table accessories should be cleaned carefully after every surgical procedure. Use clean cleaning equipments.



NOTE! Surface of the mattresses is electrically conductive. Cleaning of the mattresses should be done with neutral detergent (pH 7-8) and warm water applied with a single use wipe.

4.1.1 Cleaning

- Accessories and mattresses are cleaned separately. Unlock and remove all accessories.
- Clean by wiping down with a mild alkaline detergent (pH 7-8).

4.1.2 Disinfection

- Remove accessories and mattresses.
- Disinfect only when necessary.
- Wipe down the equipment with the surface disinfectant used at the facility in accordance with disinfection and manufacturer instructions, unless the surface disinfectant contains phenols and alcohol, which can corrode plastic parts and mattresses of the operating table.



NOTE! Dry the operating table carefully immediately after cleaning or disinfecting.

4.1.3 Mattresses and pads

The memory foam mattresses are protected against bacteria and fungus. Disinfection e.g. chloramine based diluted disinfectant. Cleaned as described in section 4.1.1.

5. SPARE PARTS

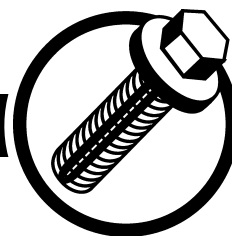

5.1 Arm rest 125

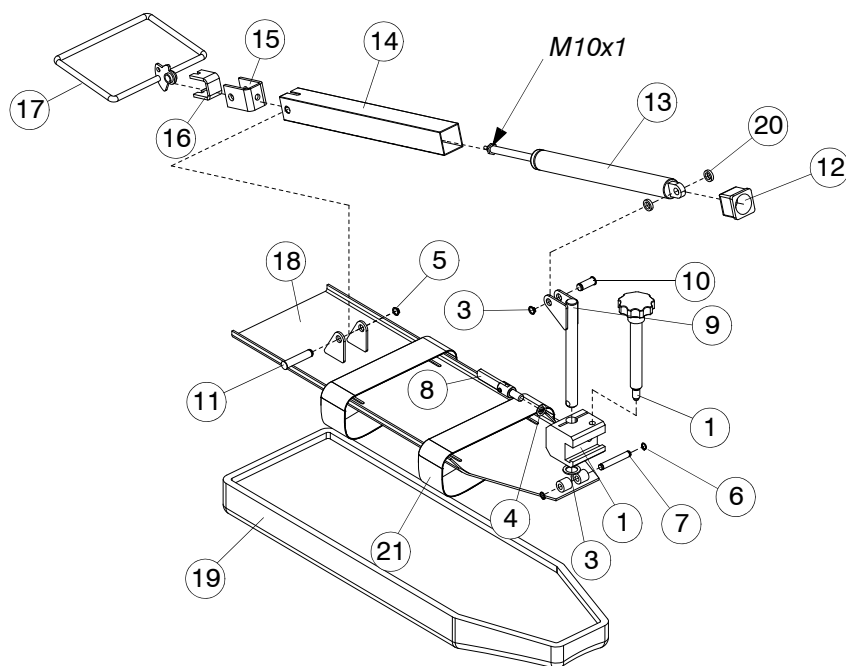

01019bp.eps

			Number of parts in assembly	
Part	Code	Part name	Additional information	
1	A4955900	Hand screw		1
2	A45161A00	Lock profile		1
3	A4791600	Washer		1
4	71458	Washer		1
5	70792	Retaining ring	DIN 471-10x1	2
6	70791	Retaining ring	DIN 471-8x0,8	2
7	A4791100	Pivot pin		1
8	A4526700	Screw		1
9	A4790800	Axle		1
10	A4791000	Pivot pin		1
11	A4761700	Pivot pin		1
12	709781	Protective sleeve bearing		1
13	71256	Gas spring	220N / 150mm	1
14	A3357300	Protective sleeve		1
15	A3357400	Mounting bracket		1
16	A3357500	Ram mount		1

			Number of parts in assembly	
Part	Code	Part name	Additional information	
17	A3636400	Release handle		1
18	A3636200	Top plate		1
19	713287	Pad	INTEGR.2-4341 125	1
20	709873	Bushing	3,5 mm, PP 4-8851/6	2
21	100000110	Strap 110		2

5.2 Devided foot section 100000148 for OP1650 and OP1700

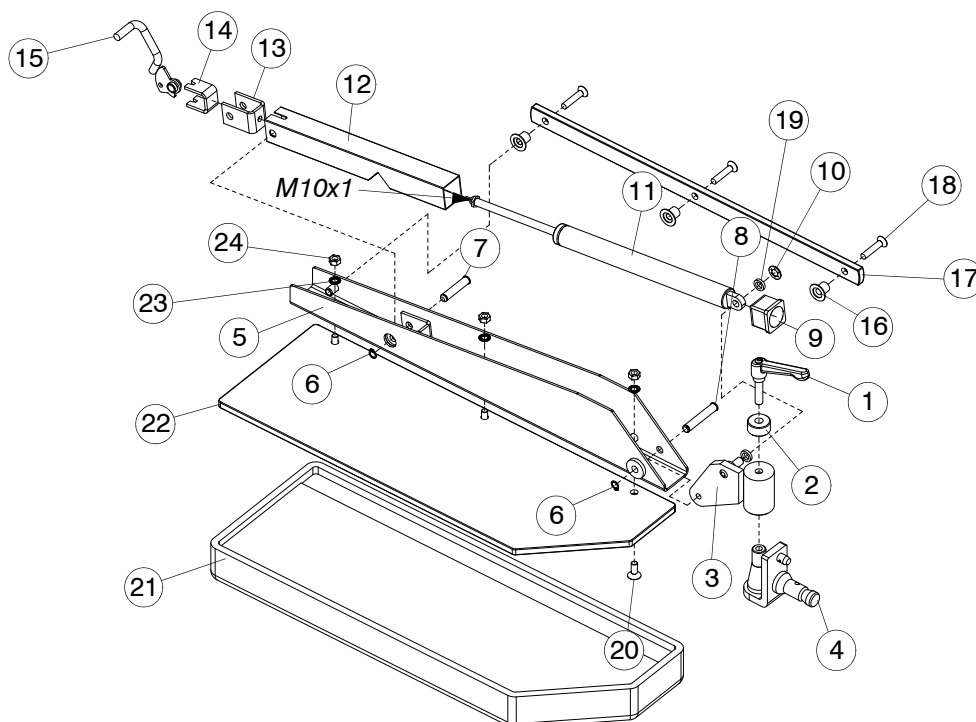

			Number of parts in assembly	
Part	Code	Part name	Additional information	
1	714945	Hand screw		1
2	A4770400	Bushing		1
3	A3625100	Mounting bracket	Right side	1
	A3625101	Mounting bracket	Left side	

			Number of parts in assembly	
Part	Code	Part name	Additional information	
4	A3624900	Foot section joint	Right side welding assembly	1
	A3624901	Foot section joint	Left side welding assembly	
5	A2425500	Frame	Right	1
	A2425501	Frame	Left	
6	707919	Retaining ring	DIN 471-10x1 A2	2
7	A4761700	Pivot pin	51 mm	1
8	A4770300	Pivot pin	61 mm	1
9	709781	Protective sleeve bearing		1
10	707991	Capping piece		1
11	712551	Gas spring	420N / 130mm with M10x1 nut	1
12	A3622800	Protective sleeve		1
13	A33574A00	Mounting bracket		1
14	A33575A00	Ram mount		1
15	A4586000	Release handle		1
16	A4857500	Accessory rail bushing		3
17	A4761600	Accessory rail		1
18	706655	Screw	M8X40 A2 DIN7991	3
19	709873	Plastic bushing	PP 4-8851/6	1
20	A4628900	Plate fixing screw		3
21	713285	Mattress		1
22	A3625201	Leg section plate	Right	1
	A3625200	Leg section plate	Left	
23	707721	Serrated lock washer	DIN6798 J8,4	3
24	707321	Nut	M8 SFS 2067 A2	3

6. RECYCLING

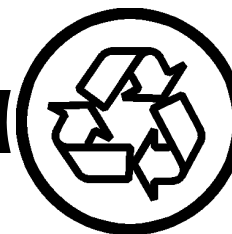

6.1 Metals and plastics

When disposing accessories or replacing any of their parts, check the recyclability of each item. Metal parts are to be recycled. When recycling plastic parts, determine the material type. For more information on recycling, contact your local waste management facility or visit related sites on the Internet.

Below are recycling symbols, which are marked on parts made of plastic. Products marked with these symbols can be used as energy waste.



PET



PE - HD



PE - LD



PP



PS



0

6.1.1 Gas springs

Gas springs can be disposed as metal waste after all nitrogen gas and oil has been removed from them.



WARNING!

Releasing nitrogen gas is strictly prohibited, without following the proper instructions. Your sales representative will provide the necessary instructions for the correct disposal of gas springs.

NOTES

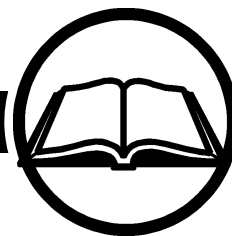

ORDER FORM

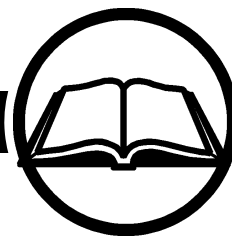

Delivery address:

Invoicing address:

Mark / reference:

Mark / reference:

Orderer:

Telephone:

Order date:

Transport mode:

[illegible]

Information:

Merivaara Corp.
Puustellintie 2
FI - 15150 LAHTI, FINLAND

Telephone: +358 3 3394 611

Fax: +358 3 3394 6249